



Series

GM GxxxxWB4: 2-1/2", 3-way, NPT female

GM HxxxxWB4: 3", 3-way, NPT female

GM JxxxxWB4: 4", 3-way, NPT female

Features

- Provides proportional control of water flow in heating ventilating and air conditioning applications.
- Includes robust maxi bonnet linkages.
- Plug design enables smooth control across full valve stroke.
- Optional DDSTM kit protects actuator from steam heat (The kit is available separately and factory installed).



Models

Size	2-Way Models	Cv	Kv	Close Off PSI	
				T	R
2-1/2"	GM G0740WB4	74	64	54	108
3"	GM H1010WB4	101	87	37	80
4"	GM J1700WB4	170	147	-	32

Valve & Actuator Selection

Close-off Type	Valve Sizes (3-Way)	Digital	Analog	Linkage
Lower Close-off & Cost Savings	2-1/2", 3"	TT Series	TM Series	Maxi Bonnet
High Close-off	2-1/2", 3", 4"	RT Series	RM Series	Maxi Bonnet

Technical Data

Specification		All Models
Valve Flow Type		3 Way: Linear
Stem Lift		2-1/2" to 4" valves: 1" stroke
Maximum Working Temperature		+281°F (+138°C)
Maximum Differential Pressure		Water: 10 PSIG recommended, (35 PSIG max.) Steam: 15 PSIG Maximum (<i>For steam applications, add BBDDSTM.</i>)
Maximum Close-Off Pressure		Refer to Valve Selection Chart (page #39)
Maximum Working Pressure		175 PSIG up to +150°F Decreasing to 125 PSIG at +281°F
Materials	Body	Cast iron with Black Lacquer Finish ANSI B16.1 Class 125
	Seat	Bronze
	Stem	Stainless Steel
	Plug	Brass
	Packing	Spring Loaded TFE
End Connections		Raised Faced Flanges, Class 125



Dimensions

3 Way, 2-½" - 4" Single Seat with TT, TM, RT, & RM Actuators

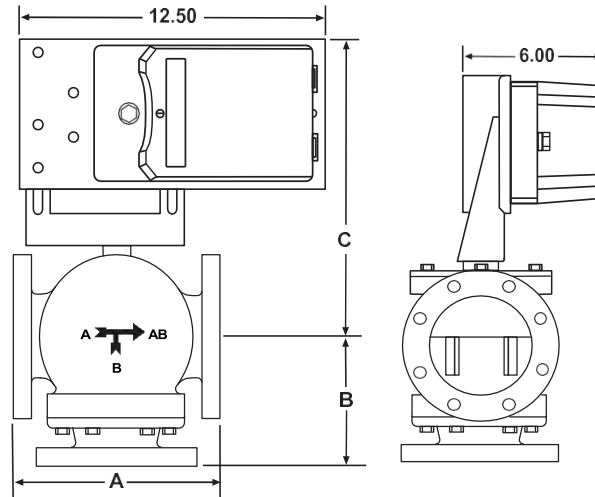

VALVE SIZE	2 WAY VALVE MODELS	VALVE DIMENSIONS			FLANGES		BOLT HOLES		BOLTS REQUIRED		
		A	B	C	THICK	DIAM	DIAM	BHC	QTY	DIAM	LGTH
2-½"	GM G0740WB4	8.50	5.38	12.63	0.69	7.00	0.75	5.50	4	0.625	2.50
3"	GM H1010WB4	9.50	6.38	12.88	0.75	7.50	0.75	6.00	4	0.625	2.50
4"	GM J1700WB4	11.50	8.50	13.50	0.94	9.00	0.75	7.50	8	0.625	3.00

Note: All dimensions are measured in inches and may vary depending on the supplier. Changes can occur without prior notice.



Recycling at end of life: please return this product to your Neptronic local distributor for recycling. If you need to find the nearest Neptronic authorized distributor, please consult www.neptronic.com.